



Fire Rated Steel Door

Duodex fire rated steel doors, tested at Warrington U.K., are 2 hour and 4 hour rated. Our Fire rated steel door come in single leaf and double leaf.

Our Fire rated steel Doors have received the unique acceptance from Warrington, UK, that permit our doors to be used and fixed with ten (10) different types of locksets approved for fire resisting steel doors.

This comes in a mixture of cylindrical locks and mortise locks. A glass panel is allowed in the door for viewing purposes. The fire rating of different types of glass affects the fire rating of the door.

These fire doors are uninsulated in nature. To increase the insulation, rockwool infill will be added. This will also increase the acoustic capability of the door.

Where stainless steel frames are required, the gap between the mild steel door leaves and the stainless steel frames must be increased to 4mm. Where both are stainless steel door leaves and door frames, the door configuration must be consistent to give a balanced assembly.





Fire Rated Steel Door

Duodex Fire Steel Door are design to withstand 4 hour fire rating. Installed in compartments areas to separate different zoning areas. Areas which usually use steel doors are shopping complexes, offices and factories. These doors have been tested at Warrington, United Kingdom. The maximum size allowed is 3m x 3m.

Duodex Specification

Door Leaves

Single and double leaf fire doors are manufactured from minimum 1.0mm thick mild steel plates. These are then finished with primer.

Door Frames

The fire steel door frames are constructed from 1.2mm thick mild steel plates. All doors have bracing for fixing purposed and these are primer finished.

Locksets

We are one of the few companies which can use several locksets like ASSA, Dorma, BKS, Suzuki and a few more. We have approval for 3 types of door closers.

Door Closers

Our company is allowed to use 3 types of door closers for fire steel doors. They are Dorma, Geze and NHN.

Hinges

On any door leaves, there are 3 number of hinges (Duodex brand).

Flush Bolt

Only on double leaf door there is a flush bolt on one side of the door leaf (Duodex Brand). One at the top of the door leaf and one at the bottom. The purpose of the flush bolt is to enable the door to be locked if necessary.

Door Selector

The door selector is only applicable on double leaf doors and is installed at one side of the door leaf. Door selector is used to ensure that the door leaf without the lockset will close first to ensure both door leaves will close properly.

Kick Plate

On both sides of the door stainless steel kick plates can be installed to prevent the door from being dented.

Vision Panel

A Vision panel of 600mm by 600mm or 300mm in diameter is the maximum size available. The limit of the type of glass limits the fire performance of the doorset , these limits are :-

Pyroshield safety clear glass	60 minutes
Pyran S Glass	180 minutes
Firelite Glass	240 minutes

Push Bar

Instead of a lockset, one side of the door can be installed with a push bar. This item is optional and is easier to use when an emergency occurs



Door closer



Flush Bolt



Lock set



Hinge

FIRE RATED STEEL DOOR

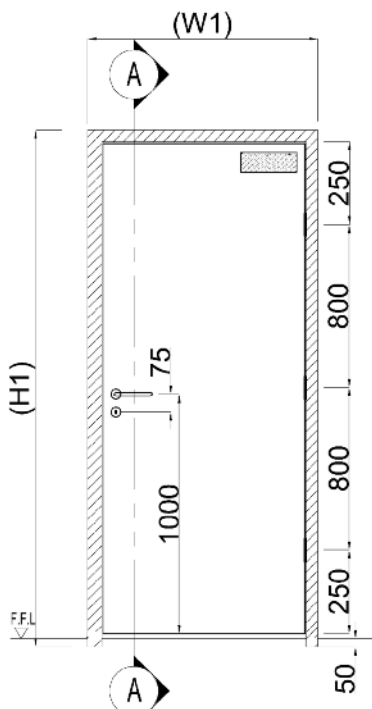

ELEVATION

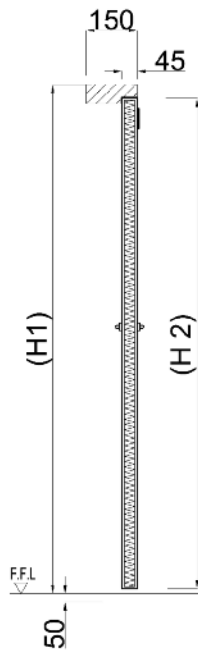

SECTION A-A

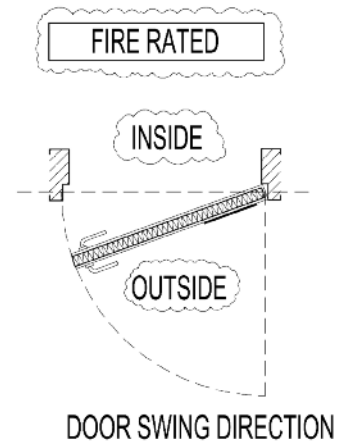

DOOR SWING DIRECTION

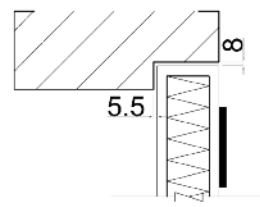

DETAIL A

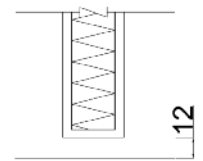

DETAIL B

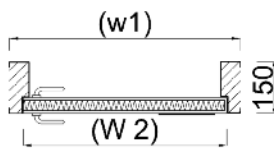

DOOR PLAN

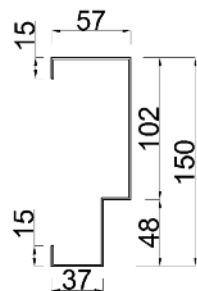

DOOR FRAME SECTIONAL DETAIL



Special Custom Design Fire Rated Steel Door

